

TOOLS YOU WILL NEED

FOR PREPARING YOUR WALLS

WALL FILLER

SANDPAPER

FOR INSTALLING THE MURAL

• SFE TRIMMER AND OR, WALLPAPER SCISSORS (TO CUT THE PAPER)

• WALLPAPER PASTE

• BUCKET - TO MIX THE PASTE IN

• PLUMB LINE OR SPIRIT LEVEL

• TAPE MEASURE

• PAINT BRUSH OR ROLLER AND

ROLLER TRAY -FOR APPLYING THE PASTE

• WALLPAPER BRUSH OR SMOOTHER

FOR ENSURING PAPER IS STUCK DOWN

• SEAM ROLLER - TO ENSURE SEAMS ARE LEVEL

• CLEAN DAMP CLOTH - TO CLEAN OFF ANY PASTE ON WALLPAPER SURFACE OR SMOOTH SEAMS

STEP 1: PREPARE YOUR WALL

- 1 Fill and sand any cracks or imperfections on your wall.
- 2 Clean the wall with detergent or sugar soap.
- 3 On fresh plaster, "size" the wall – this means make up a diluted solution of paste and liberally apply to the walls being decorated and let it dry. This will be absorbed into the porous plaster and will stop the paste being absorbed when it is applied.
- 4 When ready to start hanging your Mural, be prepared to continue until all 'drops' are hung, avoiding long periods between hanging each strip. Work from left to right.

STEP 2: MEASURE AND PLAN WHERE TO START

- 1 The first strip of the Mural is key as all others will align to it, so it is important to ensure it is "plumb" otherwise your Mural could look wonky.
- 2 Measure 48cm out from your starting point and make a pencil mark.

TOP TIP

The reason for this is that a 'drop' of the Mural is 50cm wide. It means that the last strip you hang will go into the corner. If the wall is wonky or out, you can trim it in the corner and it won't be obvious.

- 3 Using this mark, draw a plumb line using either a plumb-bob or spirit level. A plumb line is a vertical straight line, from which you will hang the first strip of your Mural against and ensure it hangs straight down. The position of the first strip determines the overall look of the completed mural, so take your time to place it accurately.

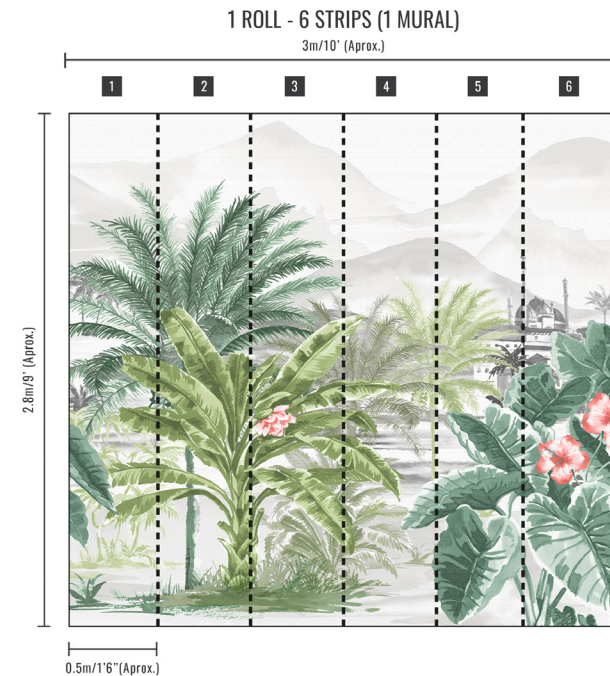

STEP 4: APPLY THE MURAL TO THE WALL

- 1 When ready to start hanging your paper, be prepared to continue until all strips are hung, avoid long periods between hanging each strip.
Work from left to right.
- 2 First trim off the hanging instructions, keeping nearby for reference.
- 3 Cut the first strip of your mural from the roll.
- 4 Apply paste the wall wallpaper adhesive to the wall, covering enough area for the first strip and a little extra, this will help when hanging your next strip.

CONTINUED - STEP 4: APPLY THE MURAL TO THE WALL

- 5 Apply the first strip to the wall, lining up to your plumb line / straight edge. Use a soft cloth or wallpaper smoother to gently work out any large air pockets downwards and outwards. Take care not to overwork each strip as this could result in stretching, making it harder to line up following strips.
- 6 Carefully remove any excess paste from the front of the mural using a lightly dampened cloth. Too much rubbing or cleaning may remove ink from the paper.

TOP TIP

Take care not to overwork each 'drop' as this could result in stretching, making it harder to line up following 'drop'.

- 7 Repeat steps 4 to 7 for the remaining strips of your wall mural, lining up the design and tightly butting up each join so that no gaps can be seen.
- 8 Trim any excess edges carefully after applying the paper.
- 9 When all the strips of the mural have been hung, remove any excess wallpaper paste from the wall with a damp cloth.

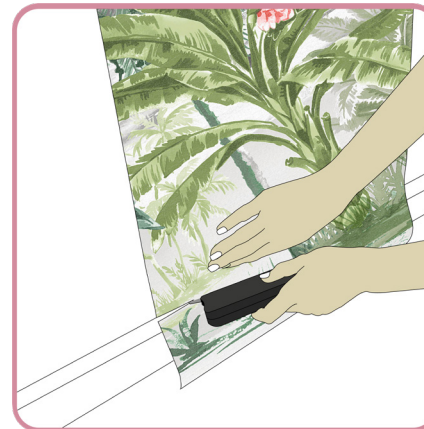
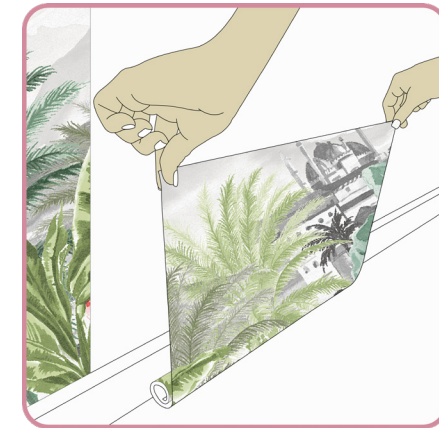
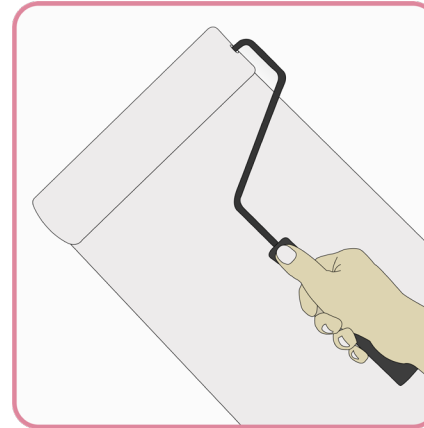

STEP 5: RELAX AND ENJOY!

www.wallpaper-it.com

